

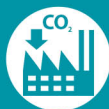

**GOL PUMPS
TECHNOLOGY INC**



HOT WATER CIRCULATOR PUMP





Hot Water Circulator Pump



Performance Curves:

4M

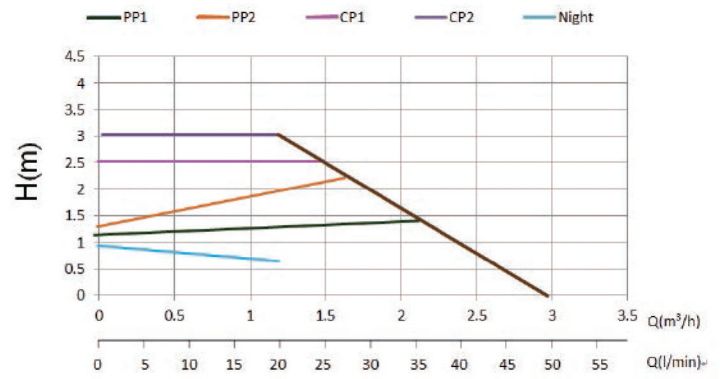
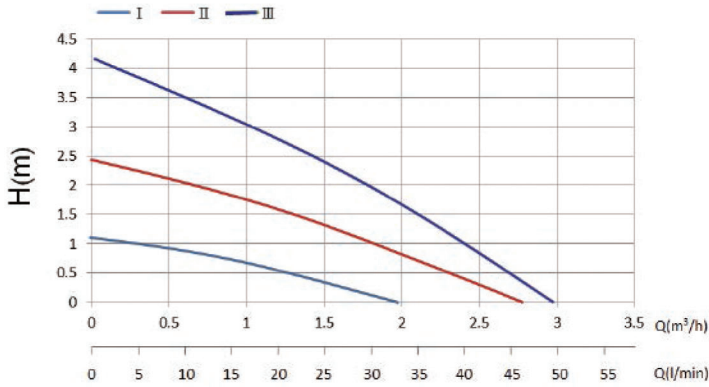

6M

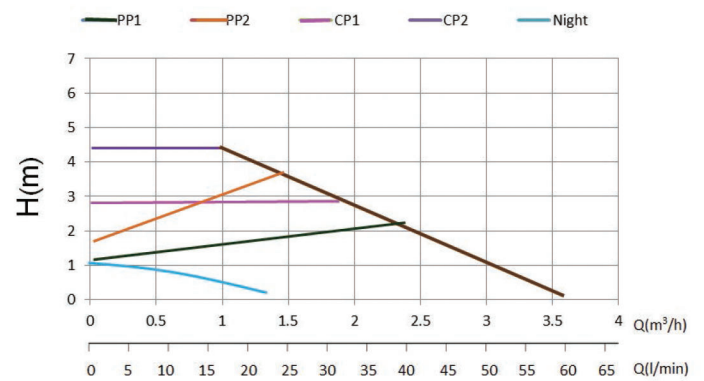
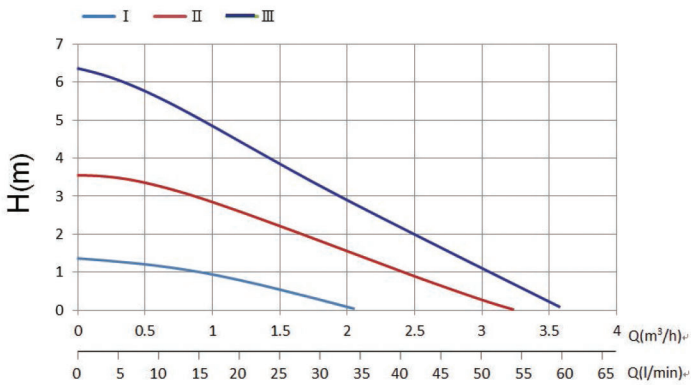

Dimensions:

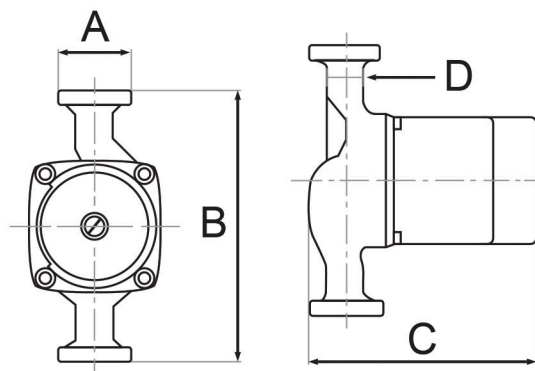

Dimensions(mm)	
A	1-1/2"
B	130 or 180
C	175
D	3/4"

Specifications:

Model	Freq. (Hz)	Phase Ø	Voltage	Max.Flow (L/min)	Max.Head (m)	Power (W)	Inlet/Outlet	Weight(kg)
AHW(S)-25-40-130	50/60	Single	220-240V	49	4	3-23	1-1/2	2.15
AHW(S)-25-40-180	50/60	Single	220-240V	49	4	3-23	1-1/2	2.45
AHW(S)-25-60-130	50/60	Single	220-240V	60	6	4-40	1-1/2	2.15
AHW(S)-25-60-180	50/60	Single	220-240V	60	6	4-40	1-1/2	2.45

S = stainless steel version

Optional Accessories

Union Sets

Inlet/Outlet	Material
2/1-1 x 4/3	304 SS
2/1-1 x 1	304 SS

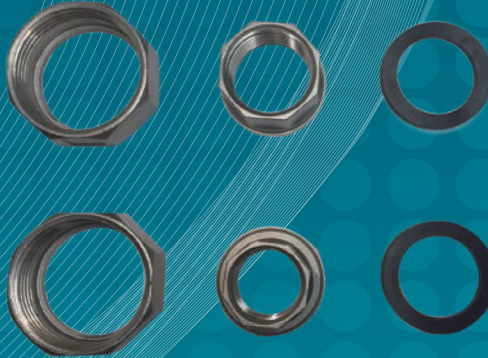

Note:
Specifications subject to change without notice.

3750 NW114 AVE #6 MIAMI , FL 33178

Ph: +1 (786) 615 8984 Fax: +1 (786) 615 7043

www.golpumps.com

Info@golpumps.com