

Tipo - Type	TABELLA - TABLE - TABLEAU - TABLA																	Peso Weight Kg		
	A	B	C	D	E	F	G	H	I	L	M	N	O	P	/	/	/		DNa	DNm
JCA120 - SERIE	550	147	123	280	305	335	270	563	118	355	90	90	140	18	/	/	/	100	65	86
JCA125 - 570A4	490	147	123	220	305	335	270	584	139	355	90	90	140	18	/	/	/	125	80	113
JCA125 - 340A4																				
JCA125 - 570B4	490	147	123	220	305	335	270	563	118	355	90	90	140	18	/	/	/	100	80	96
JCA125 - 520C4																				
JCA125 - 340B4																				
JCA125 - 320C4																				

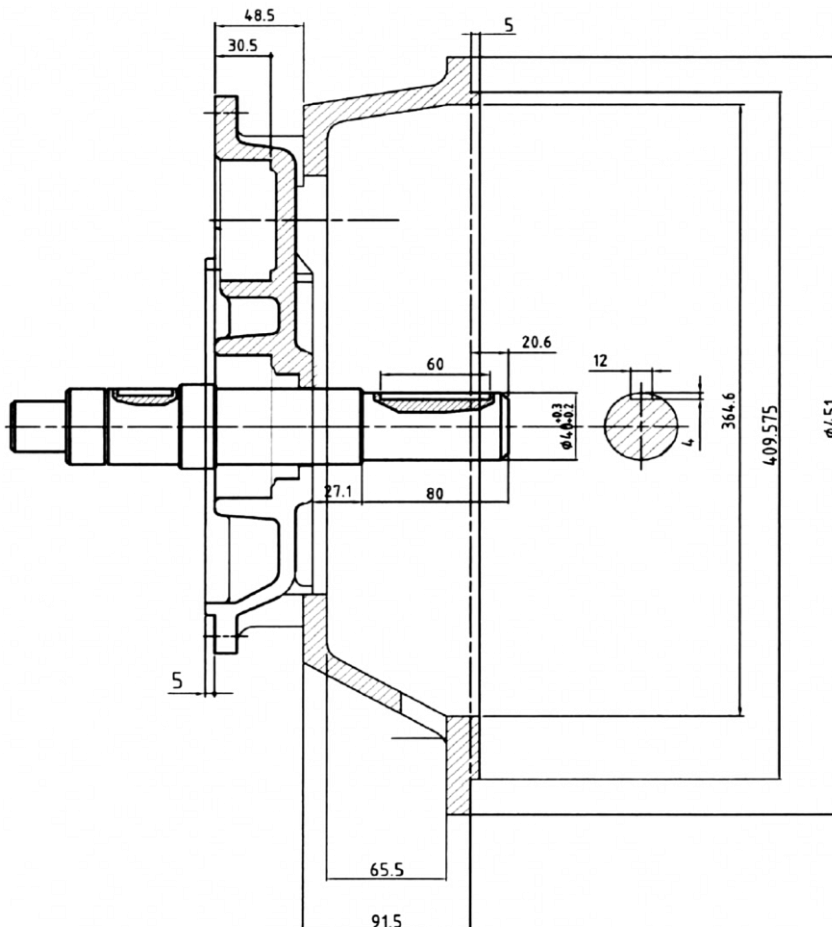

Ingombro della Flangiatura SAE rispetto alla presa di forza montata sulla pompa. Ad ogni ingombro dei vari modelli di pompa bisogna aggiungere quello di questo disegno.

The SAE Flange Size with respect to the PTO mounted on the pump. Every design of the pump models must be added to this drawing.



Misure in millimetri / Measurements in millimeters



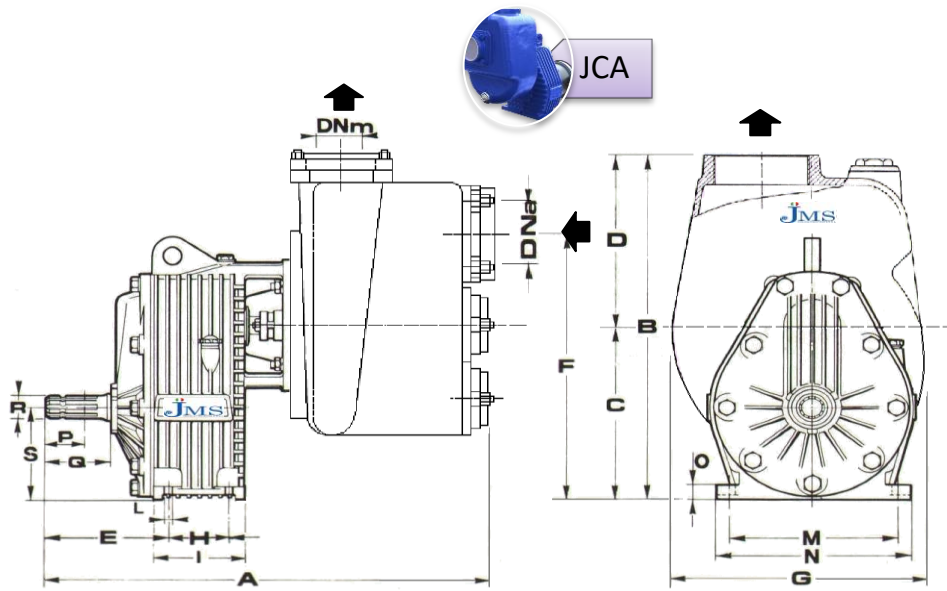

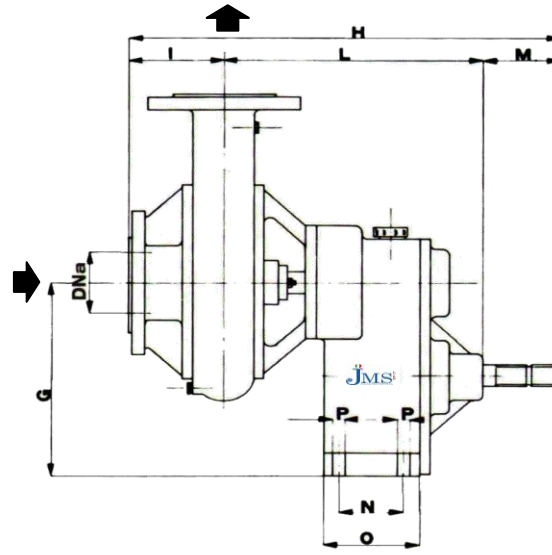
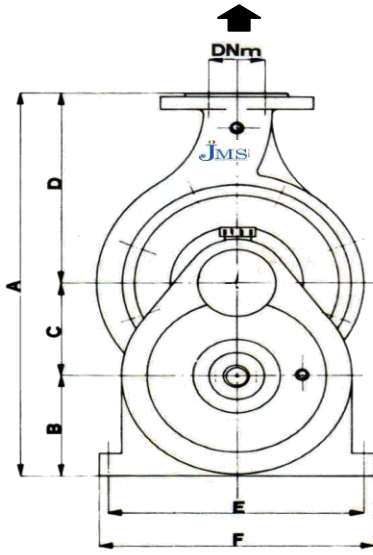

PAT  
PATA

PAT  
PATA

PAT  
PATA

PAT  
PATA

PAT  
PATA

PAT  
PATA

PAT  
PATA

PAT  
PATA