

### Pump Data

Brand :	Gol Pump		
Model :	GFO-332		
Head Rate :	26 FEET	Flow Rate:	133 GPM
Head Max:	46 FEET	Flow Max:	346 GPM
Head Min:	6 FEET	Flow Min :	5 GPM
RPM :	1800		
Normal Power P1 :	3 HP		
Fluid:	Water		
Fluid Temperture:	at about 25 °C		
Density:	water 997 kg/m <sup>3</sup>		
Fluid Viscosity:	8.90 × 10 <sup>-4</sup> Pa·s		
With Float switch	NONE		
Self Priming	Submersible		
Delivery size	3" NPT		
Suction size			
Made in :	TAIWAN		

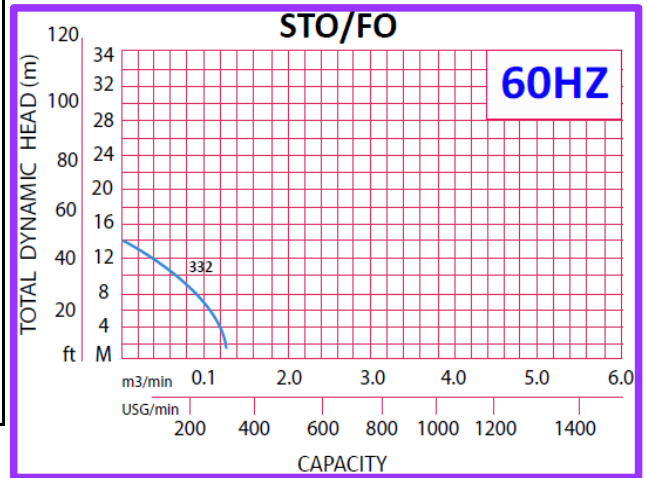

### Motor Data

Power P2:	*		
Power P1:	2.2 KW		
Phase (PH):	3		
Rate Voltage :	230 V		
Capacitor Need :	*	MF	
Ferequency :	60 Hz		
Rated Speed (rpm):	1800 rpm		
Current (A):	8.6 A		
Cos φ :	0.85		
Degree of Protection (IP):	IP 68		
Safety Protection Included:	E		
length of Cable :	3.5 × 10	mm2×m	
Kind of Plug :	NONE		
Ambient Temp :	40°C = 104°F		

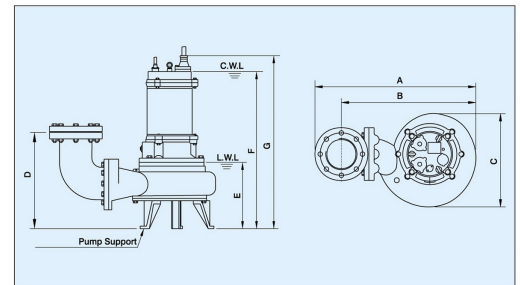

### Other Pump Data

Impeller Size (mm) :	*		
Pressuer Rating :	PN 16		
Min. Fluid Temp :	10°C = 50°F		
Max. Fluid Temp :	40°C = 104°F		
Ambient Temp :	40°C = 104°F		
Humidity % :	100%		

### Special Specification

Installation status :	Ver		
Variable frequency :	NONE		
Solid Passage	40 × 50	mm	

### Materials

Pump Body :	Cast Iron
Support:	Cast Iron
Impeller	Cast Iron
Mechanical Seal:	Silicon Carbide
Rubber	Steel
Pump Shaft:	SUS 304
Strainer	Cast Iron
outer cover:	Cast Iron
Motor:	Cast Iron

### Shaft Seal

Type:	*
Stationary Part	SUS 304
Rotating Part	SUS 304
Elastomer	Cast Iron

### Pump and Motor specification optional

With Booster System	None
With Complack	None
Special Material	None
Specail Voltage	None

### Protection system required

External Flout switch	NONE
Minimum Starter	Starter SWT

Weight : 213.7 Lb  
Standard Approve

### Applicant:

Dimention in

CSA		Effluent Pumping in Industrial Waste Water	A	22.8
		Treatment Plants Sewage Waste Water and Solid	B	18.7
UL		Treatment in Various Factories and Building	C	12.2
		Sites Food Processing Factory Confined	D	13.6
		Livestock Feeding Industry Restaurants and	E	10.9
CE		Shops Markets and Super Markets	F	24.7
			G	28.1