



# Technical Data

## Vertical In-line Pump - EGM65-5032-07504

Revision no.

Page:

1

Receiver

From

 Company name  
 Respons. Department  
 Person in charge  
 Phone number  
 Fax no  
 E-mail address

**Brand: Gol Pumps**  
**Model: EGM65-5032-07504**  
**Flange: ANSI Class 125**

### Motor (V1)

Model	HP
Y2-132M-4	10

### Weight (lb)

Pump	Motor	Pump & Motor
218	173.8	391.8

### Inlet      Outlet

2.5"	2.5"
------	------

### Dimensions:

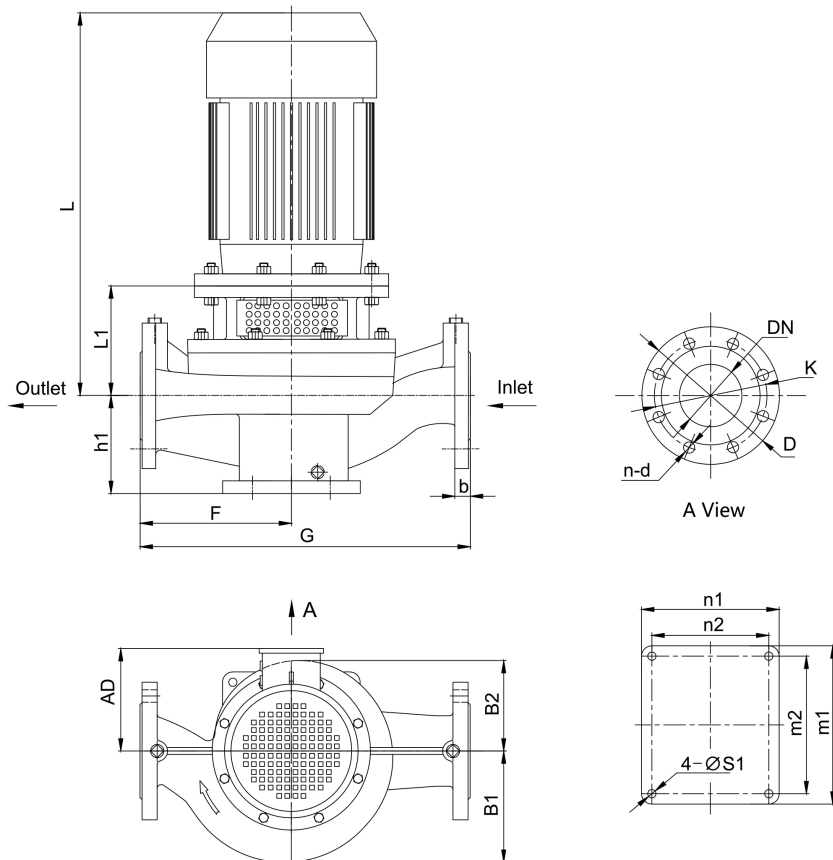

### Pump Installation Size (inch)

h1	L1	F	G	L	AD	B1	B2	n2 x m2	n1 x m1	S1	DN	D	K	n - d	b
6.1	9.1	11.4	23.2	29.3	10	8.4	7.8	6.7x7.9	7.9x9.1	0.6	2.5	7.1	5.5	4 - $\phi$ 0.8	-

Project

Project ID

Created by

Created on

Last update



# Performance Curves

## Vertical In-line Pump - EGM65-5032-07504

Revision no.

Page:  
 2

Receiver	From

Company name  
 Respons. Department  
 Person in charge  
 Phone number  
 Fax no  
 E-mail address

Model	Capacity			Head		Speed r/min	Motor hp	Voltage v	Phase	Impeller Diam.		Eff. %	(NPSH)r ft
	m <sup>3</sup> /h	l/s	gpm	m	ft					mm	inch		
EGM65-5032-07504	25.9	7.2	114.1	33	108	1710	10	230/460	3	267	10.5	45	6.2
	43.2	12	190.2	30	98		10					52	8.9
	51.8	14.4	228.2	26	85		10					51	11.5

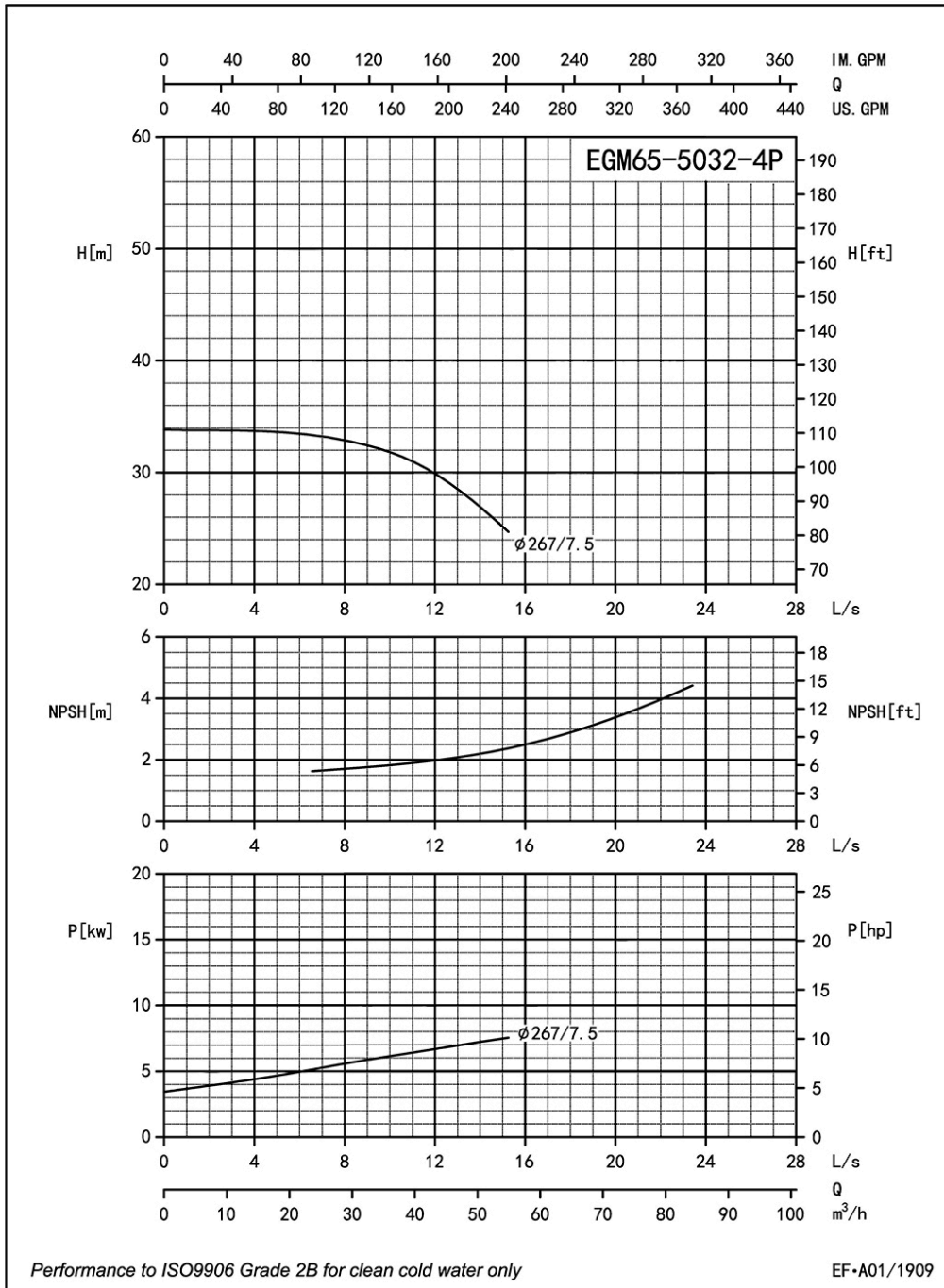

Project	Project ID	Created by	Created on	Last update
---------	------------	------------	------------	-------------



# Parts List

## Vertical In-line Pump - EGM65-5032-07504

Revision no.

Page:  
 3

	Receiver	From
Company name		
Respons. Department		
Person in charge		
Phone number		
Fax no		
E-mail address		

### Parts List

1 Casing	14 Screw
2 Impeller Nut	15 Screw Bolt
3 Flat Washer	16 Screw Nut
4 Spring Washer	17 Screw Bolt
5 Front-Wear Ring	18 1/4 Plug
6 Impeller	19 3/8 Plug
7 Seal Seat	20 Key
8 Mech Seal	21 Screw Nut
9 Casing Gasket	22 Motor
10 Casing Cover	23 Key
11 1/4 Plug	24 Screw
12 Adapter	25 Shaft
13 Guard	

Project	Project ID	Created by	Created on	Last update