

JURBOTC

300



ELETTROPOMPE SOMMERSIBILI BICANALI PER ACQUE CARICHE
SUBMERSIBLE TWIN-CHANNEL ELECTRIC PUMPS FOR WASTEWATER

PREVALENZA : 82 ft.
PORTATA : 50 m³/h

PUMPHEAD : 82 ft
DELIVERY : 50 m³/h

APPLICAZIONI

- SVUOTAMENTO DI FOSSE DI DECANTAZIONE, POZZI NERI, POZZI DI RACCOLTA LIQUAMI.
- POMPAGGIO DI ACQUE LURIDE ANCHE CON CORPI SOLIDI IN SOSPENSIONE.
- MOVIMENTAZIONE DI ACQUE LURIDE AD USO DOMESTICO ED INDUSTRIALE.

APPLICATIONS

- DECANTATION PIT, SEWAGE PIT AND SLURRY COLLECTION PIT PUMP OUT.
- PUMP OUT OF LAVATORY/FOUL WATER WITH POSSIBLE FLOATING SOLIDS CONTENTS.
- DOMESTIC AND INDUSTRIAL LAVATORY/BLACK WATER HANDLING SYSTEMS.

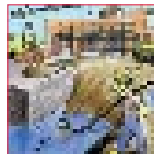

Gol Pumps Technology Company
 Supply, Import, Export Water Pumps

CARATTERISTICHE DI COSTRUZIONE:

- MOTORE A BAGNO D'OLIO (BIODEGRADABILE E DIELETTRICO) PER RAFFREDDAMENTO E LUBRIFICAZIONE CUSCINETTI.
- DOPPIA TENUTA MECCANICA: LATO MOTORE A BAGNO D'OLIO. LATO POMPA A BAGNO D'ACQUA.
- IMMERSIONE MASSIMA: 33 ft.
- GRADO DI PROTEZIONE IP 68 .
- CLASSE DI ISOLAMENTO: F.
- TEMPERATURA MAX. LIQUIDO POMPATO: 95°F.
- PASSAGGIO LIBERO: 1 in.
- VERSIONI:
Trifase: 230V/60Hz con protezione da sovraccarico a cura dell'utente.
- CAVO STANDARD:
Trifase: 33 ft H07RN-F senza spina.

SPECIALE VOLTAGGIO E FREQUENZE A RICHIESTA.

DESIGN ENGINEERING:

- OIL BATH MOTOR (BIODEGRADABLE AND DIELECTRIC) FOR COOLING AND BEARING LUBRICATION.
- DOUBLE MECHANICAL SEALS: ENGINE FACE: OIL BATH. PUMP FACE: WATER BATH.
- PERMISSIBLE HEIGHT OF WATER: 33 ft.
- IP 68 PROTECTION CLASS.
- CLASS "F" INSULATION.
- MAX. PUMPED LIQUID TEMPERATURE: 95°F.
- BY PASS SECTION: 1 in
- VERSIONS:
Three Phases: 230V/60Hz with overload protection care of the User.
- STANDARD CABLE FEATURES:
Three Phases: 33 ft H07RN-F without connection plug.

CUSTOMIZE VOLTAGE AND FREQUENCY RATING AVAILABLE ON DEMAND.

TABELLA MATERIALI / MATERIALS TABLE:

Pos.	Componente / Component	Materiale / Materials	
A	Coperchio / Cover	GHISA (G20) / CAST IRON	
B	Guarnizione / Gasket	GOMMA / RUBBER NBR 70	
C	Carcassa motore / Motor housing	GHISA (G20) / CAST IRON	
D	Albero / Shaft	ACCIAIO INOX AISI 416 DIN 1.4005 / STAINLESS STEEL	
E	Tenuta meccanica / Mechanical seal	Lato Motore / Motor side	DOPPIO ANELLO DI TENUTA NBR NBR DOUBLE SEALING RING
		Lato pompa / Pump side	CARBURO DI SILICIO/ALLUMINA SILICON CARBIDE-ALUMINA
F	O-ring	NBR	
G	Flangia inferiore / Upper flange	GHISA (G25) / CAST IRON	
H	Girante / Impeller	GHISA (G20) / CAST IRON	
I	Diffusore / Diffuser		
L	Piattello / Disk base	ACCIAIO INOX AISI 304 DIN 1.4301 / STAINLESS STEEL	

JURBO TC 300

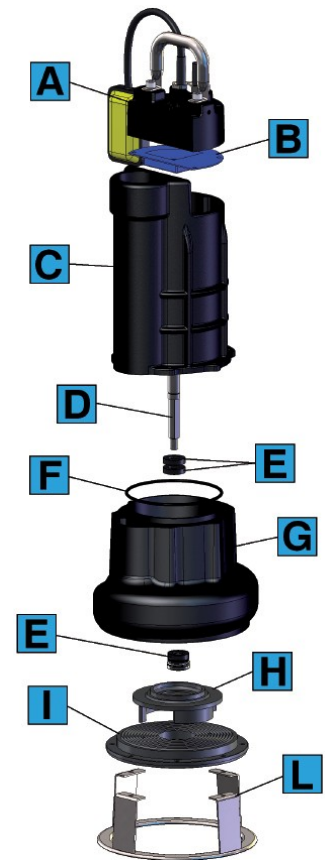

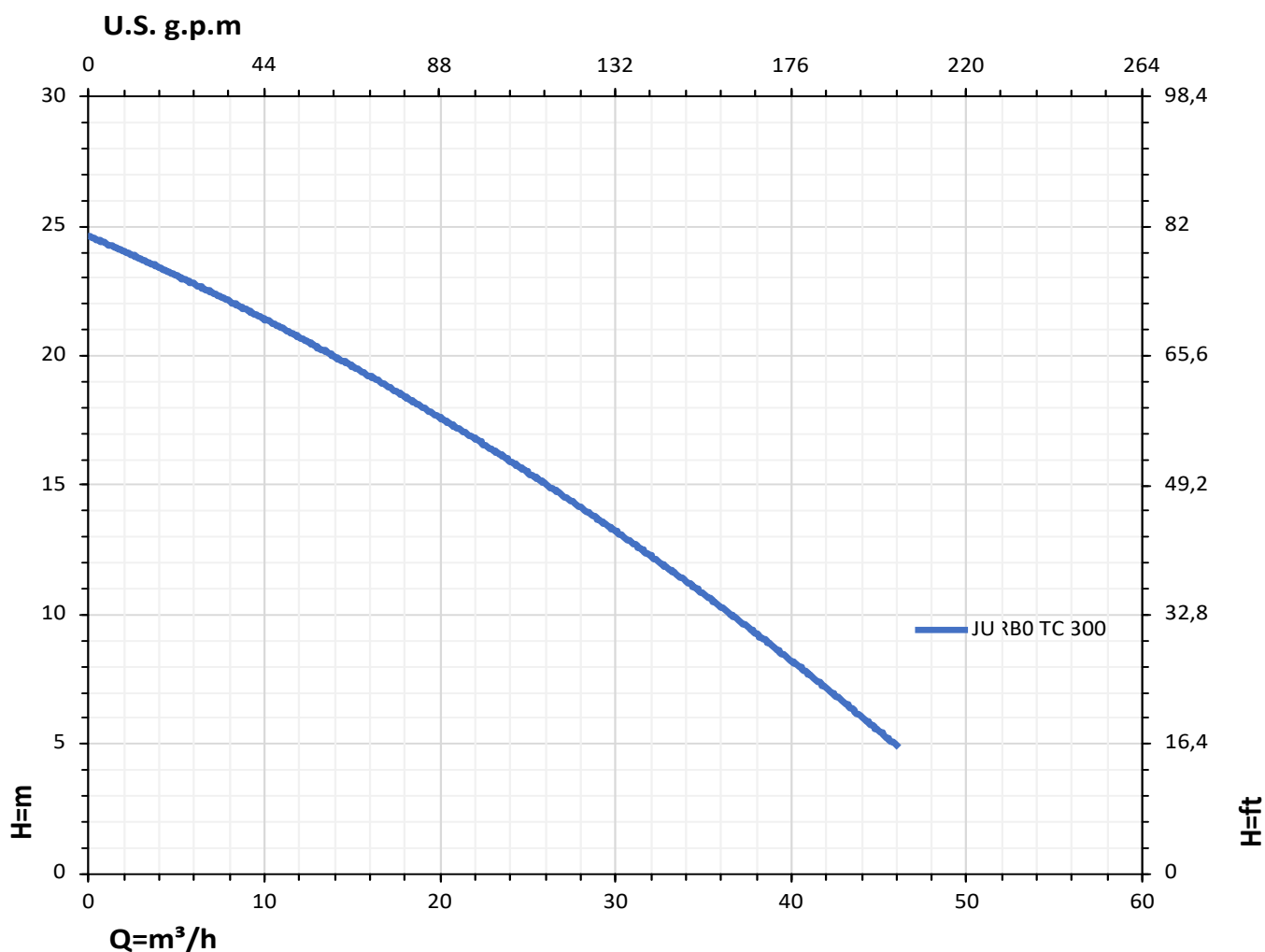

Caratteristiche di funzionamento a 3450 rpm 60Hz - Performances at 3450 rpm 60 Hz

Le prestazioni valgono per liquidi con densità $\rho = 1,0 \text{ kg/dm}^3$ ed una viscosità $\nu = 1 \text{ mm}^2/\text{s}$ / The performance data holds true for liquids with a $\rho = 1,0 \text{ kg/dm}^3$ density and a $\nu = 1 \text{ mm}^2/\text{s}$ viscosity.

MODELLO/ MODEL	VOLTAGGIO VOLTAGE 60 Hz	DATI ELETTRICI ELECTRICAL DATA				DATI IDRAULICI/ HYDRAULIC DATA							
		P2 max	I max	Condensato Capacitor		m³/h	0	3	12	21	30	42	50
		HP	Ampere	µF	VC	g/min.	0	13	53	92	132	185	220
JURBO TC 300 T	3 x 230V	5.4	13	---	---	H (ft.)	80	77	69	56	43	23	10

DIMENSIONI e PESI / SIZE AND WEIGHT DATA:

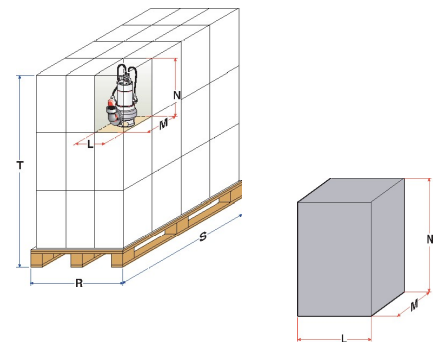
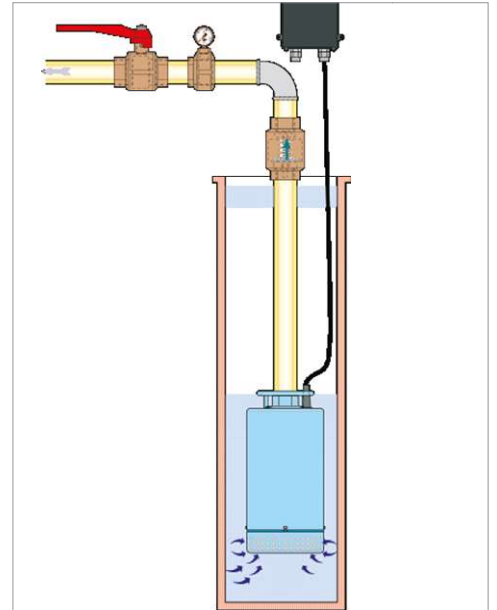
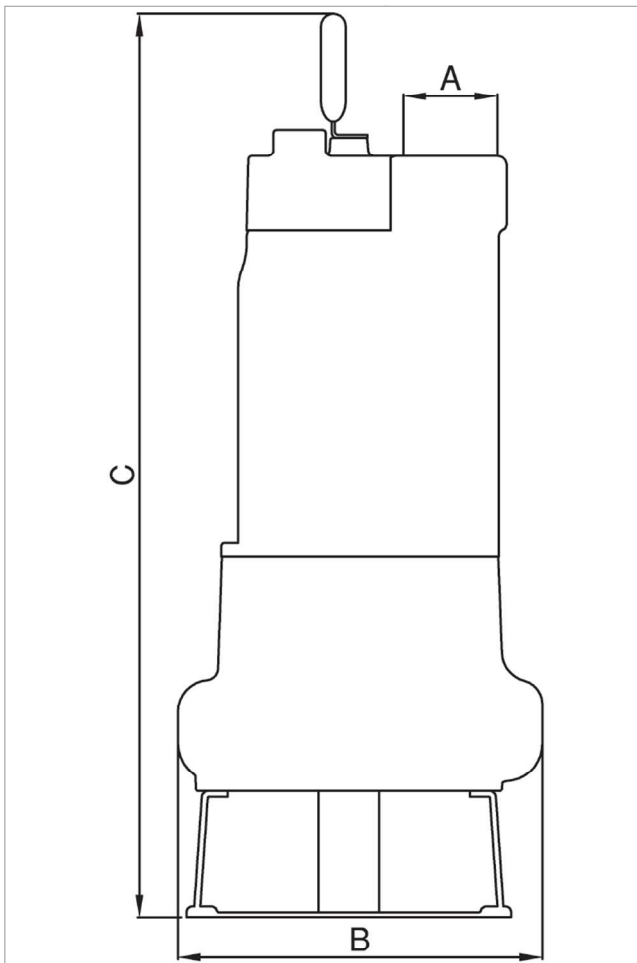

MODELLO / MODEL	DIMENSIONI POMPA in mm. / PUMP DIMENSIONS in in.		
	A	B	C
JURBO TC 300	2" NPT	2	24

MODELLO / MODEL	DIMENSIONI SCATOLA / PACKING DIMENSIONS			
	L in.	M in.	N in.	Peso / Weight lb.
JURBO-TC 300	25	10	15	99



Gol Pumps Technology Company
Supply, Import, Export Water Pumps

Gol Pumps Technology

www.golpumptechnology.com

Our Address: 6520 NW 77th CT, Miami FL 33166, USA

Sales DPT: +1 786 615 8984

After Sales Service: +1 786 452 9775

Fax: +1 786 615 7043

Email: info@golpumps.com

